

CONVEX CROWN WITH CONSTANT RADIUS

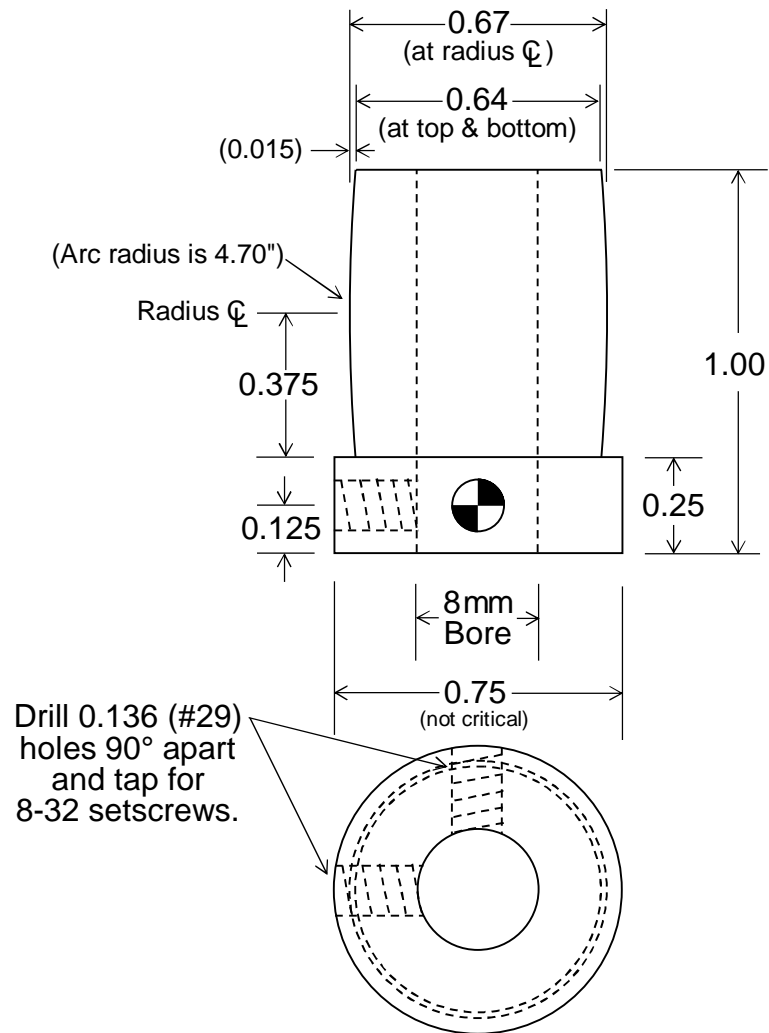

MATERIAL IS 3/4" ROUND
ALUMINUM BAR STOCK

PART IS SHOW
TWICE SIZE

STRAIGHT TAPER WITH CENTER FLAT

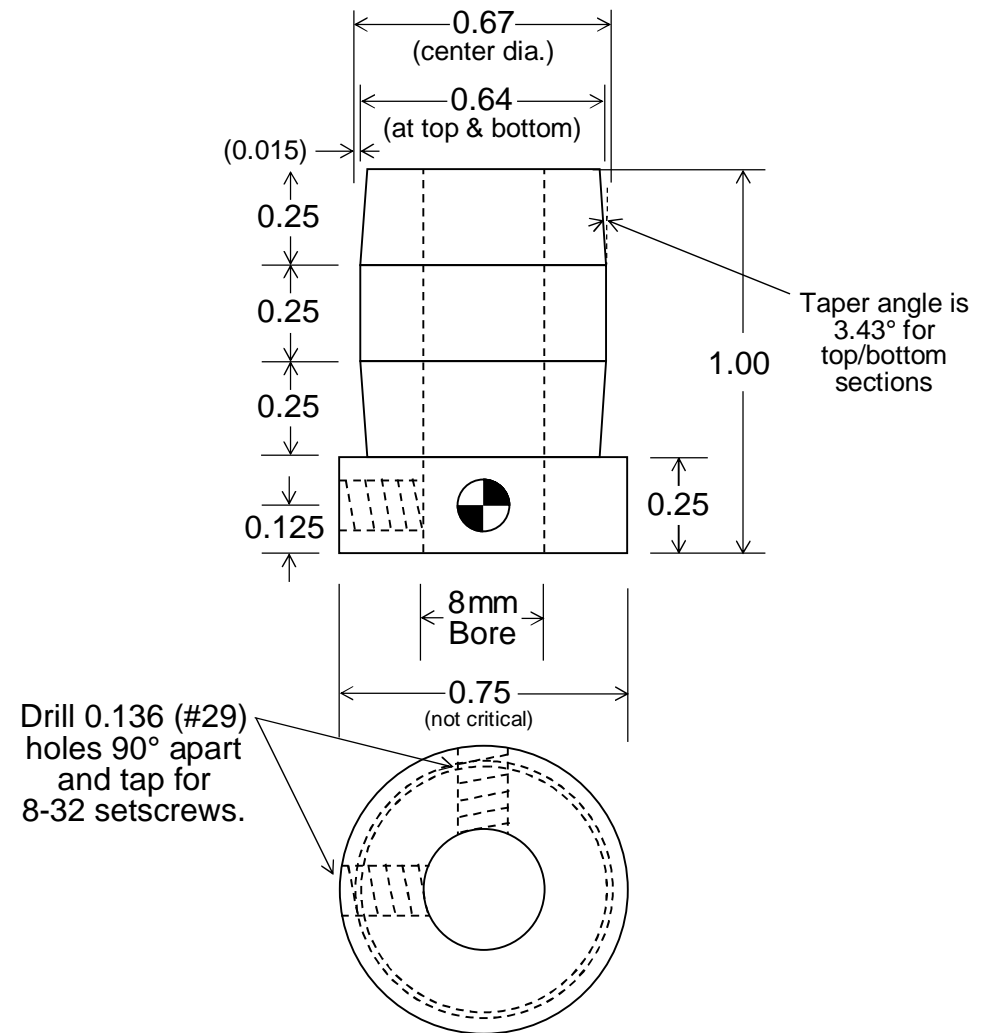

TURNTABLE MOTOR PULLEY

2024 Disc Recording Lathe Project

The Schlockwood Laboratory 10/29/2024