

17520
C

[illegible]

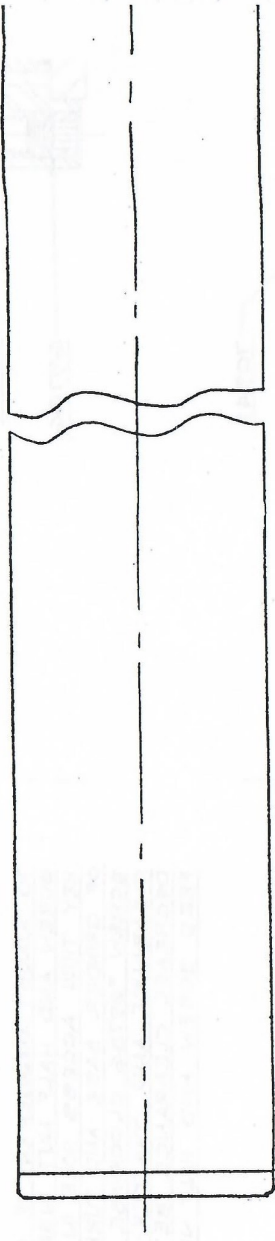

STAKE THREAD (2) PLACES
WITH CENTER PUNCH

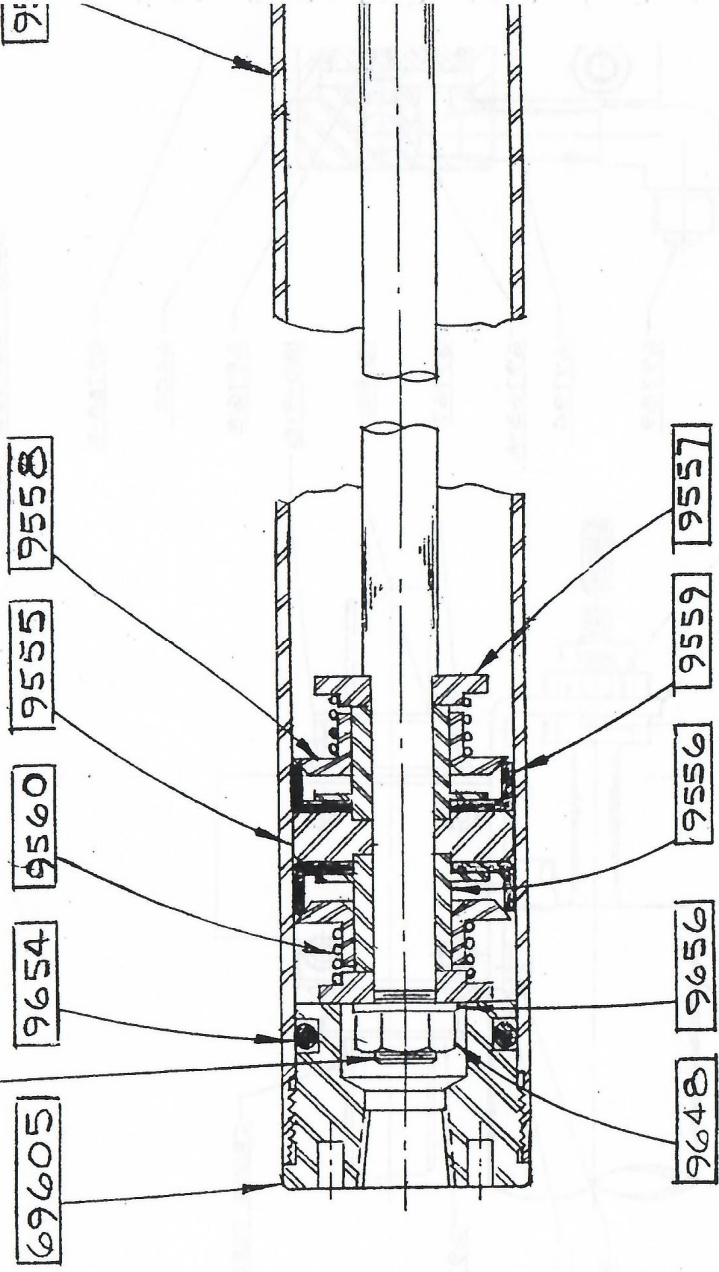

QTY	DESCRIPTION	QTY	REQ	QTY	DESCRIPTION
9558	2 EXPANDER	4400	1	9/16 O.D. X 3/8 I.D. "O" RING	
9557	2 STOP WASHER	9656	1	1218 INT. LOCKWASHER	
9556	2 EXPANDER GUIDE				
9555	1 PISTON GUIDE	9654	2	PRP-902-17 "O" RING	
9554	1 PISTON ROD	9653-A	1	3687 OIL SEAL CH1/RAW	
9553-A	1 PISTON ROD BEARING	9648	1	5/16-24 ELAS. STOP NUT	
69605	1 REAR CYLINDER END	9561-A	1	"O" RING BKK-UP WASHER	
69604	1 FRONT CYLINDER END	9560	2	EXPANDER SPRING	
9550	1 CYLINDER TUBE	9559	2	PISTON CUPS	
					MATERIAL

1- APPLY SEALANT TO BORE (CRANE)
PLS-2) BEFORE INSERTING SEAL

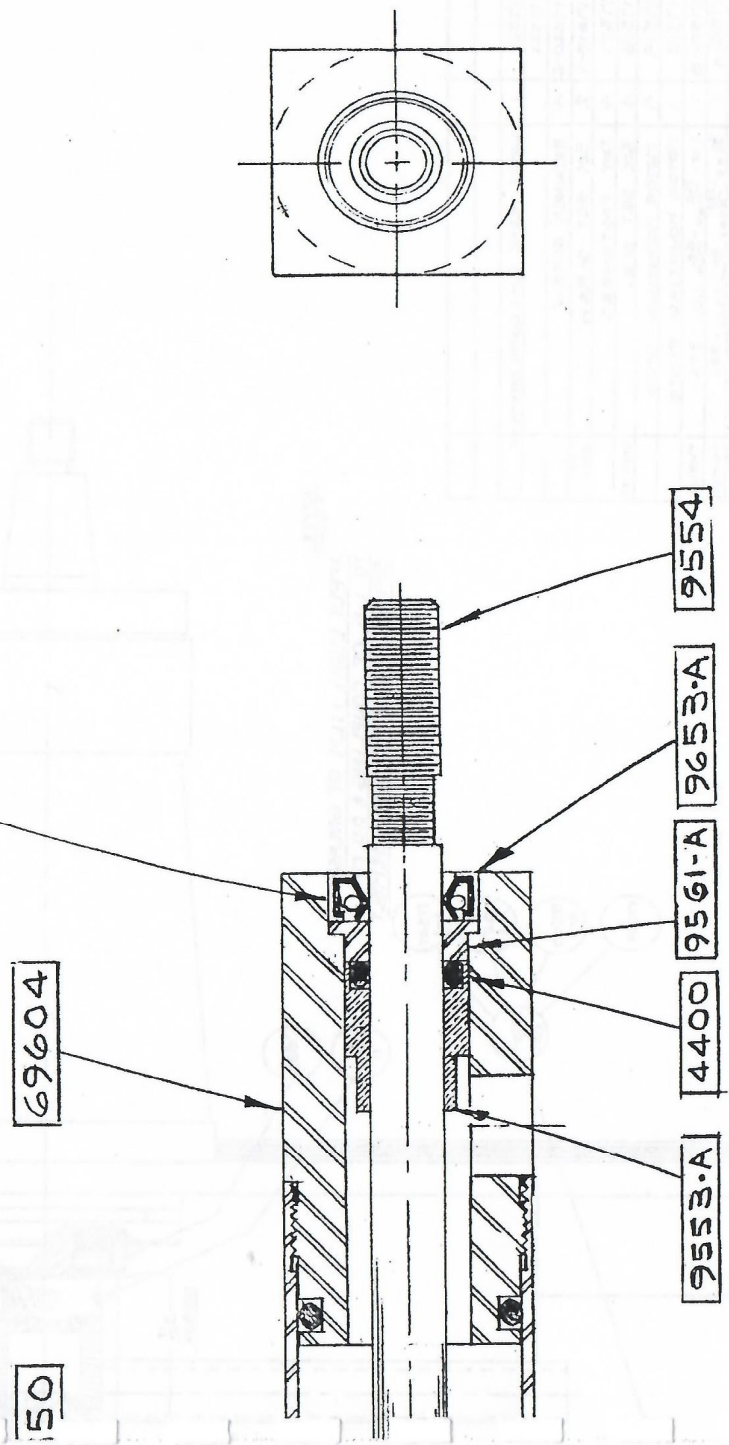
[illegible]

$\frac{5}{16} - 24 \times \frac{1}{4}$ SOC SET SCREW
2 REQD FURNISHED WITH
COUPLING

9090

16
APPROX

17
3.32
APPROX

3663

17511-
D

17507
A-1

17507
A-2

17503
A-3

17014

17507
ASSY

17508
BODY

17507
A-1

17507
A-2

17503A
A-3

17017

FOR 618 CHALLENGER HANDFEED &
HYDRAULIC GRINDERS ONLY

FOR $\frac{3}{4}$ HP TOTALLY ENCLOSED &
1 HP MOTOR ONLY

FOR 602 HANDFEED &
HYDRAULIC GRINDERS ONLY

FOR 618 CHALLENGER HANDFEED &
HYDRAULIC GRINDERS ONLY

NOTE

APPLY LIGHT FILM OF GREASE
TO I.D. OF COUPLING & O.D. OF
SPINDLE SHAFT BEFORE ASSEMBLY

17522	1	LOWER REAR DUST COVER EXTENSION	
17521			
17520-C	4	RETAINER SCREW	1 IN ONLY
17518-A	2	SOC SET SCREW	1 IN ONLY
17517	4	DOT FASTENERS	CONE PT
17515	4	SOC SET SCR.	
17514	4	MOTOR MOUNTING STUD	
17513	1	MOTOR MOUNTING PLATE	
17512-B	1	1 HP - $\frac{115}{16}$ - 92 CYC. - 3 PH.	MOTOR
17512-A	1	$\frac{3}{4}$ HP - $\frac{115}{16}$ - 92 CYC. - 3 PH.	MOTOR ONLY
17511-D	1	COUPLING	1 IN ONLY
17511-A-2	1	COUPLING SPIDER	1 IN ONLY
17511-A	2	COUPLING	1 IN ONLY
17510-B	2	COUPLING KEY	3 PH. ONLY
17508-A	1	REAR DUST SLIDE GUIDE ASSY	L.H. ONLY
17507A-2	2	REAR DUST SLIDE GUIDE (REAR)	L.H. ONLY
17507-A	2	REAR DUST SLIDE GUIDE (FRONT)	L.H. ONLY
17507-A	1	REAR DUST SLIDE GUIDE ASSY	R.H. ONLY
17506-A	1	UPPER REAR DUST COVER	
17505-B	1	LOWER REAR DUST COVER	
17504A-2	1	REAR DUST SIDE GUIDE (L. REAR)	
17504-A	1	REAR DUST SIDE GUIDE (L. FRONT)	
17503A-3	2	EXTENSION GUIDE	L.H. ONLY
17503A-2	1	REAR DUST SIDE GUIDE (R. REAR)	2 IN ONLY
17503A-1	1	REAR DUST SIDE GUIDE (R. FRONT)	
17503-A	1	REAR DUST SIDE GUIDE ASSY	R.H. ONLY
17017	1	LH REAR DUST GUARD BRKT	
17014	1	RH REAR DUST GUARD BRKT	
9090	2	SOC SET SCREW	
3663	4	SOC HP CAP SCR.	
3023	1	DOWEL	
1447	1	DOWEL PIN	